

Instruction Manual for N120 250mm Optical Glass Wide Angle Port II

P.N. 18815

FOREWORD

Thank you for your purchase of a NAUTICAM product.

At NAUTICAM, we pride ourselves in the ability to recognise the requirements of professional as well as amateur underwater photographers and fulfill them through the innovative designs of our products. We strive to achieve a high level of user-friendliness by allowing stress-free installation and easy operation of all important functions of the camera.

Each product is individually inspected and water pressure tested to ensure optimum quality.

Please read this manual carefully before using the product, this will maximise its performance as well as its lifetime.

WARRANTY

All NAUTICAM Products are warranted against any material and manufacturing defects for two years from the date of purchase for consumer use. This warranty only applies to products purchased from authorised NAUTICAM dealers and does not extend beyond the original retail purchaser.

To return your product for service, please contact your regional authorized service centre(s). Please note that this warranty only applies when the product is purchased in the territory where the service centre is located.

NAUTICAM does not hold responsibility for damage, of any nature, to any equipment used with and/or placed within our products.

NAUTICAM accepts no liability for any loss of captured images or the inability to capture images even if it is due to the malfunctioning of our products.

Unauthorised modifications and/or repairs of our products will automatically invalidate the warranty.

IDENTIFICATION OF PARTS

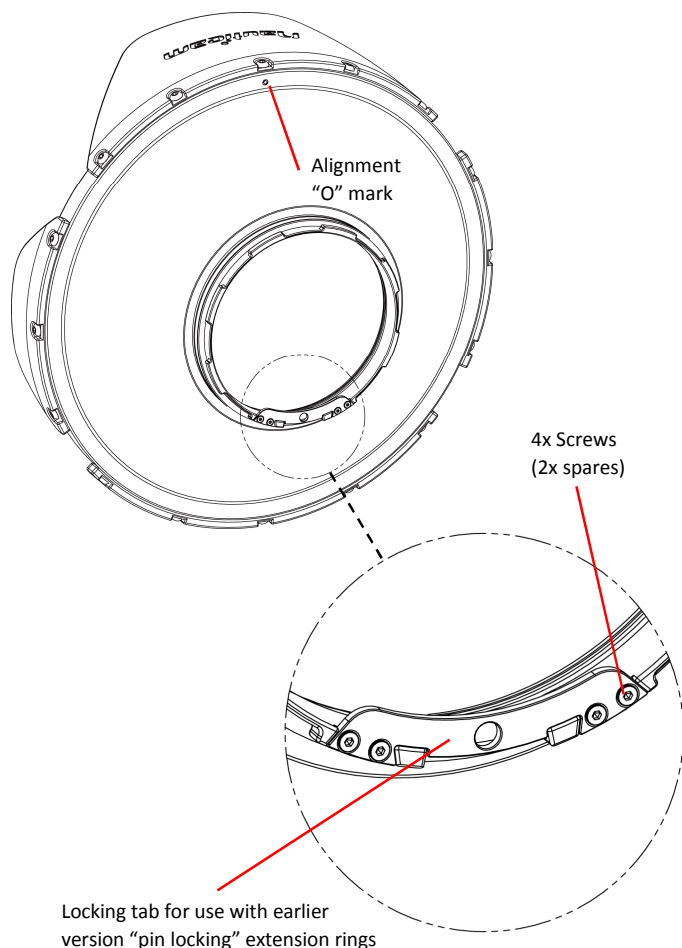

COMPATIBILITY

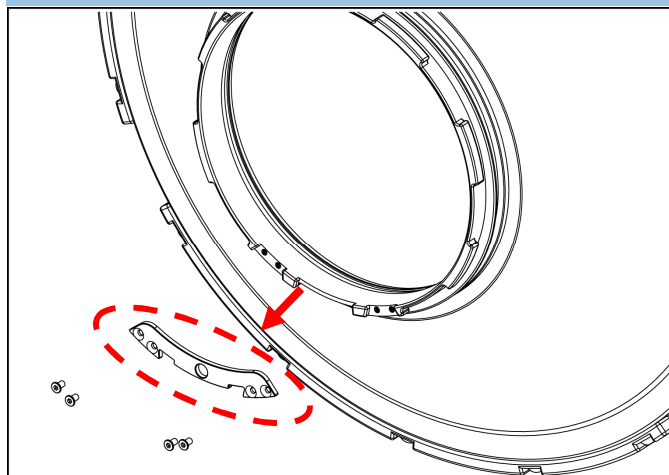

This port is backwards compatible with other N120 extension rings. A user installable locking tab is pre-installed for this purpose.

Remove the locking tab when using large diameter lenses like Canon 11-24mm lens.

Refer to the housing manual or extension ring manual for mounting the port.

CARE AND MAINTENANCE

- The port should be rinsed thoroughly in fresh water (when mounted on a housing) after each dive.
- Dry and clean the dome surface with micro fibre cloth.
- Cover the dome with the provided cover when not in use.
- Do not use any kind of abrasive solutions to clean the dome surface.

BOX CONTENTS

- N120 250mm optical glass wide angle port II
- Neoprene cover
- Rear cap
- Carrying bag
- Spare O-ring
- Spare screws (4x) for locking tab

SPECIFICATIONS

Dimensions:	Dia271mm x 131mm
Internal Diameter:	Dia109mm
Port Mount:	N120
Coating (inner):	Multi-layer broadband anti-reflective coating
Radius of Curvature:	160mm
Weight:	Approx. 2.97kg
Depth Rating:	40m