

NA - TG3

Underwater Camera Housing
Instruction manual



Foreword

Thank you for your purchase of a NAUTICAM camera housing.

At NAUTICAM, we pride ourselves on the ability to recognise the requirements of professional as well as amateur underwater photographers and fulfill them through the innovative designs of our products. We strive to achieve a high level of user-friendliness by allowing stress-free installation and easy operation of all important functions of the camera.

Each housing is individually inspected and water pressure tested to ensure optimum quality.

Please read this manual carefully before using the housing, this will maximise its performance as well as its lifetime.

Warranty

1. All NAUTICAM Products are warranted against any material and manufacturing defects for two years from the date of purchase for consumer use. Please fill in the warranty cards shipped with our housings and viewfinders at the time of sale and return them to your point of purchase within a month. If we do not receive the completed warranty card for a particular product, the warranty period would be assumed to begin from the day that the product is shipped from our facility. This warranty only applies to products purchased from authorised NAUTICAM dealers and does not extend beyond the original retail purchaser.
2. To return your product for service, please contact your regional authorized service centre(s). Please note that this warranty only applies when the product is purchased in the territory where the service centre is located.
3. NAUTICAM accepts no liability for any damage to and defects in the housing caused by improper use and/or poor maintenance; it is the responsibility of the owner to carefully follow the instructions in our manuals.
4. NAUTICAM does not hold responsibility for damage, of any nature, to any equipment used with and/or placed within our products.
5. NAUTICAM accepts no liability for any loss of captured images or the inability to capture images even if it is due to the malfunctioning of our products.
6. Unauthorised modifications and/or repairs of our products will automatically invalidate the warranty.

Package Contents

1. NA-TG3 housing
2. Instruction manual
3. Spare silicone rubber housing o-ring
4. O-ring remover
5. Lubricant
6. Set of Allen keys
7. Diffuser

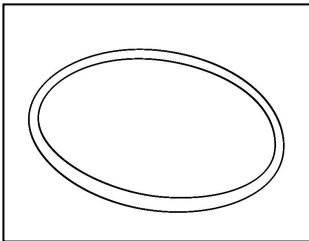

Spare silicone rubber o-ring

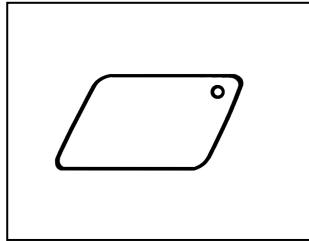

O-ring remover

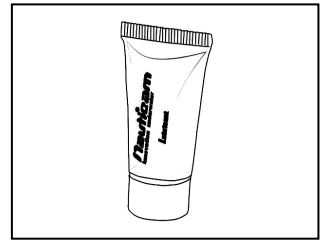

Lubricant

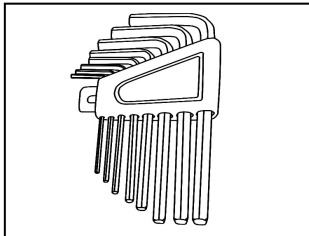

Set of Allen keys

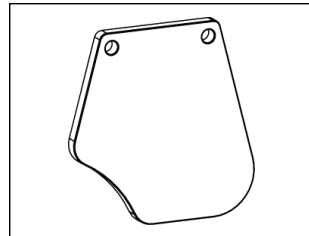

Diffuser

Precautions

1. A water-tight test without the camera inside the housing is highly recommended when using the system for the first time and after the changing of port and O-ring(s).
2. Do not use lubricants from other brands with the silicone rubber O-ring on this housing, only use the lubricant provided by NAUTICAM.
3. Discontinue use immediately should you notice any leakage.
4. Store the housing in a robust, shock-proof container during transportation; avoid transporting with any equipment, such as a camera, inside the housing.
5. When travelling by air, do not close the housing if the port is installed, as this may lead to a pressure difference between the atmosphere and inside the housing.
6. Care must be taken when opening the housing, as pressure may build up inside the housing which increases the opening force.
7. Do not open the product in a wet or sandy environment. Protect the interior from moisture and debris in order to prevent malfunction or leakage.
8. Do not store the product in an environment of high humidity.
9. Do not leave the housing and the camera in direct sunlight for prolonged periods.
10. Keep out of reach of children, failure to do so could result in injury.
11. Defective products should be shipped to our distributors for service, unauthorized disassembling and/or modifications could result in malfunction or leakage.

Table of Contents

<i>Specifications</i>	6
<i>Identification of Parts</i>	7
<i>Preparation of the Housing</i>	9
<i>Opening and Locking the Housing</i>	10
<i>Installing the Camera</i>	11
<i>Care and Maintenance</i>	12
<i>Optional Accessories</i>	13

Specifications

Construction	Housing body:	Aluminium alloy
	Surface treatment:	Hard anodised
	Display window:	Abrasion resistant polycarbonate
Dimensions	Width:	160mm
	Height:	98mm
	Depth:	65mm
Weight	Approx. 0.60kg (without camera)	
Buoyancy	Slightly negative	
Depth rating	100 metres	
Features	TTL capability:	Optical fibre mount included for external strobes connection, utilising the camera's pop-up flash as trigger.
	Mode dial wheel:	Enable easy access mode dial by right thumb.
	52mm thread on the port:	Positioned precisely for maximum wide-angle lens performance.

Identification of Parts

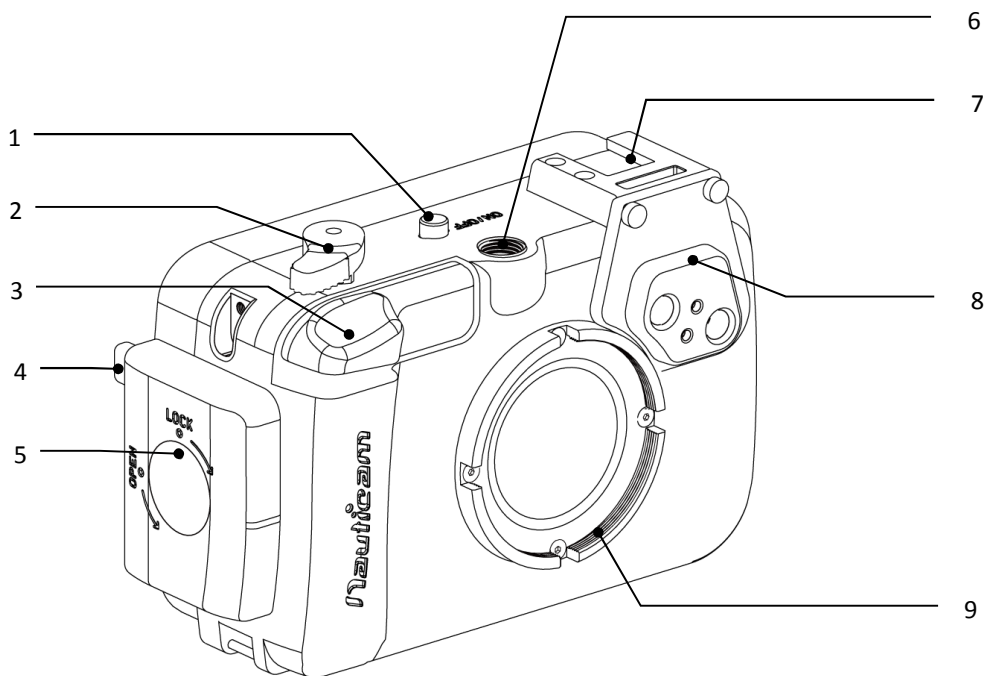

1	On/off button	6	M10 strobe mounting base
2	Zoom lever	7	Accessory coldshoe
3	Shutter release lever	8	Optical fibre mount
4	Housing lock safety button	9	Port with 52mm thread
5	Housing lock		

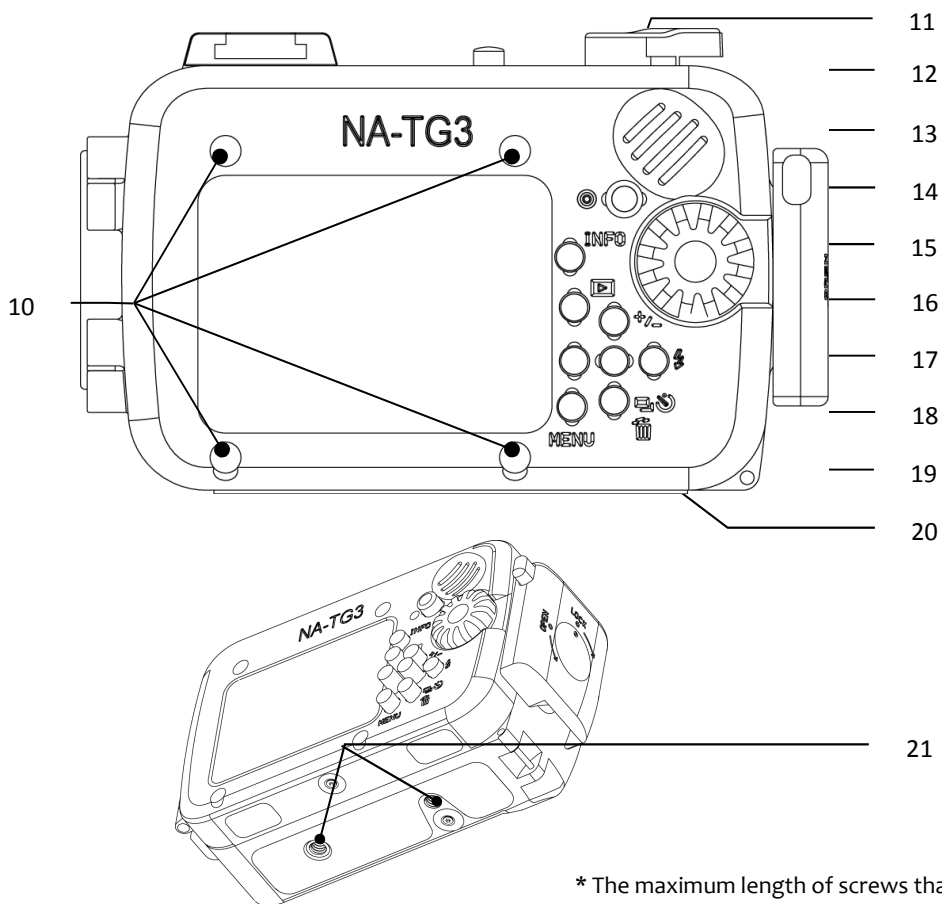

* The maximum length of screws that can be used with the tripod sockets is 4mm

10	Mounting holes for LCD Magnifier attachment rails	16	OK button
11	Info button	17	Flash/ Right selection button
12	Movie button	18	Left selection button
13	Playback button	19	Sequential shooting/ Self-timer/ Down selection button
14	Mode dial	20	Menu button
15	Exposure compensation/ Up selection button	21	1/4"-20UNC tripod socket x 2*

Preparation of the Housing

1. After verifying that the housing O-ring is in good condition, lightly coat it with the lubricant provided.
2. Make sure the O-ring groove located in the rear part of the housing is free from any foreign material; the groove can be cleaned with the aid of a microfiber cloth.
3. Place the O-ring into the groove.
4. To install flash diffuser, remove the pre-installed optical fibre mount by unscrewing the two screws, then fasten the diffuser with the screws to the threaded sockets of the accessory coldshoe as shown:

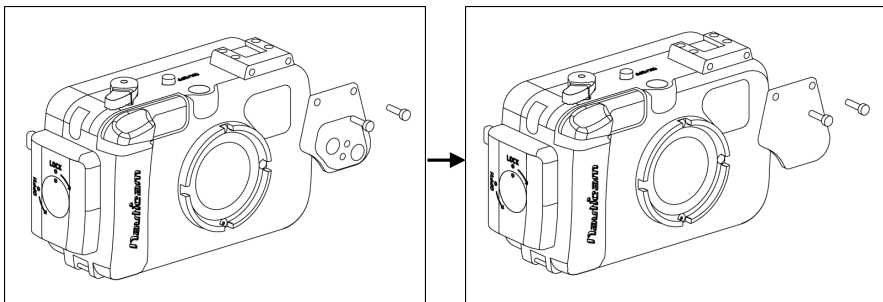

Opening and locking the housing

To open the housing:

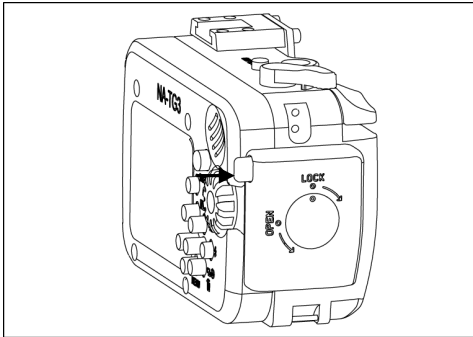

1. Press the housing lock safety button.

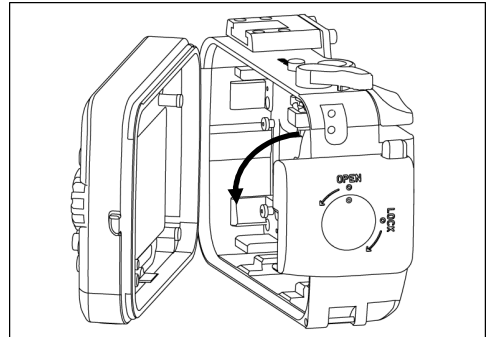

2. Turn the housing lock anti-clockwise for 270° , until the lock reaches the "Open" position as shown.

To lock the housing:

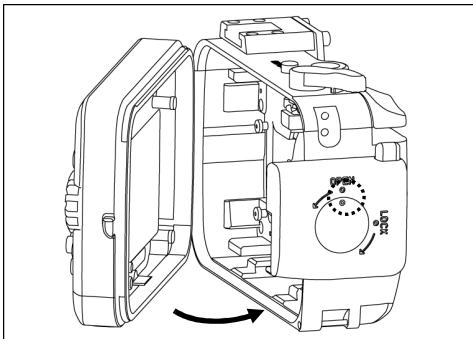

3. Close the housing while the housing lock is in the "Open" position.

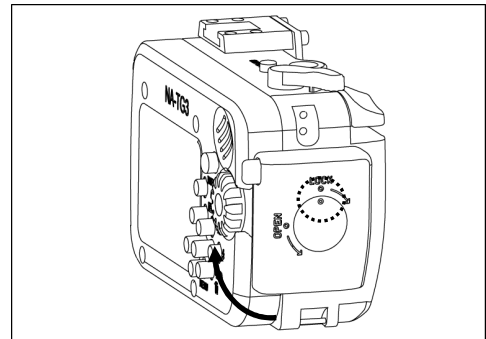

4. Turn the housing lock clockwise for 270° , until the lock reaches the "lock" position as shown. Confirm that the white indicator line on the safety button is visible.

Installing the Camera

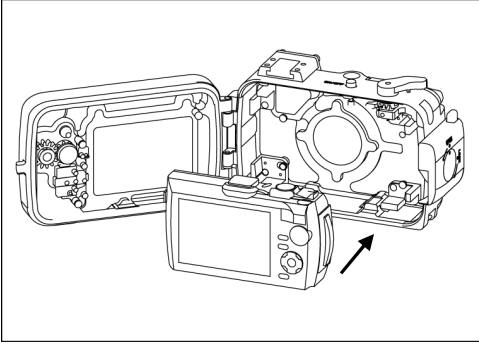

1. Place the camera inside the housing as shown.

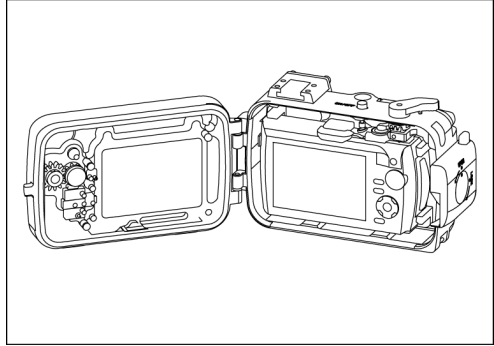

2. Confirm that all the controls of the housing are correctly engaged.

Care and Maintenance

1. Soak the housing system in fresh water after each salt water use, during which all control buttons/knobs should be operated a few times to avoid the accumulation of salt residue; wipe the housing with a towel before opening.
2. After each day of diving, it is advisable to have the main O-ring in the rear part of the housing removed from its groove with the O-ring remover and inspected for damage. Also check that the O-ring retains its original circular shape; never stretch the O-ring excessively or remove it with a sharp object. The O-ring groove should be cleaned to ensure it is free from any salt deposit or foreign material; lightly coat the O-ring with the provided lubricant before reinstalling it in the groove. A damaged O-ring should be discarded immediately and replaced only with one that is provided by NAUTICAM.
3. Replace the main O-ring annually.
4. It is recommended that you ship the housing to our distributor for a complete overhaul every year or after every 200 dives.

Optional Accessories

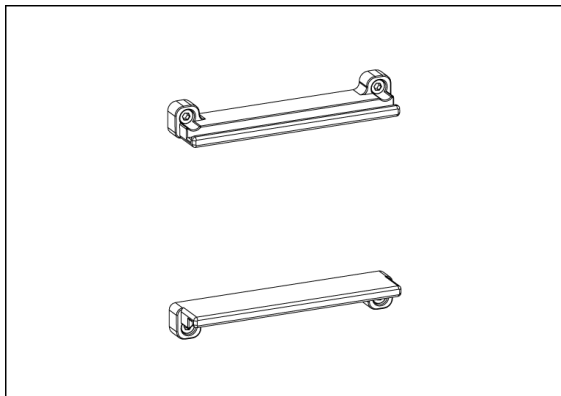

P.N. 25123

LCD Magnifier attachment rails for NA-S110/S120/TG3

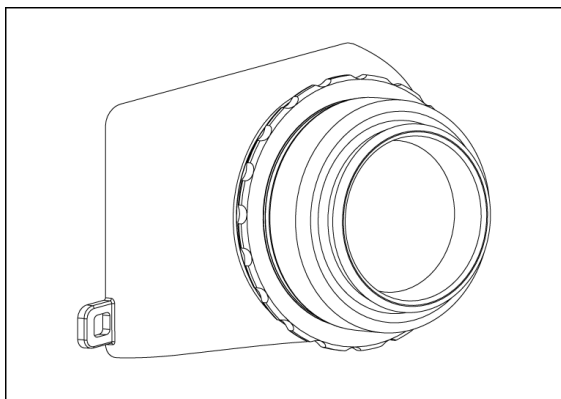

P.N. 25106

LCD Magnifier with Dioptric Adjustment

NAUTICAM International Limited
Room 2203,
CCT Telecom Building,
11 Wo Shing Street,
Fotan, HONG KONG

Email: enquiry@nauticam.com
Tel: +852 2690 2711
Fax: +852 2690 9778

