

F.I.T.

F.I.T.LED PRO 5000
Video Light For Diving

Manual

Read carefully before using

1.1 Product Construction

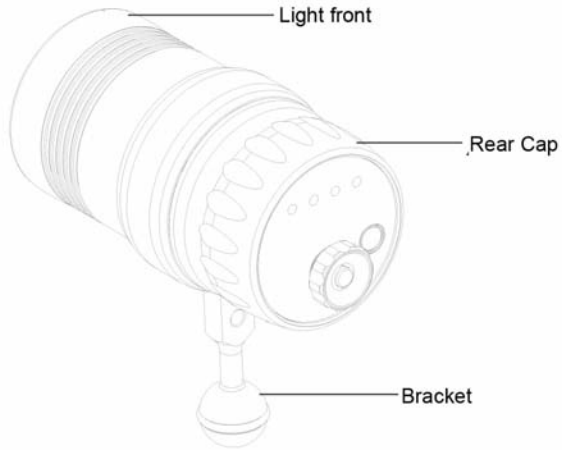

Chart 1 Construction

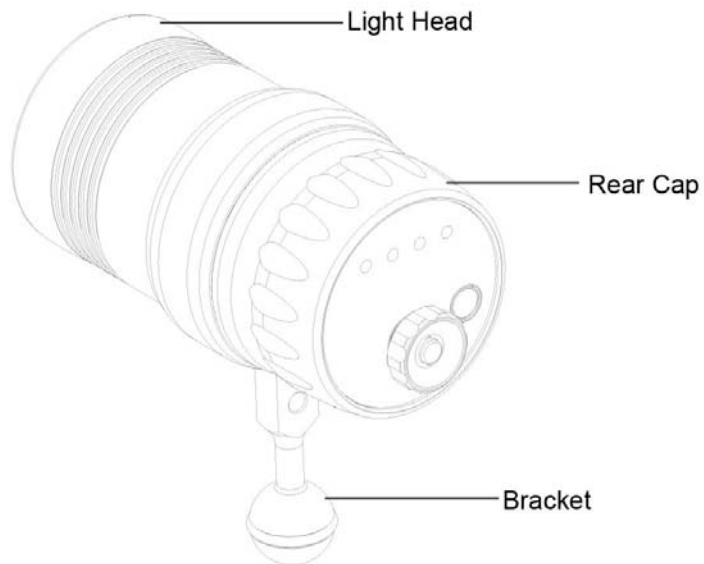

Chart 1 Construction

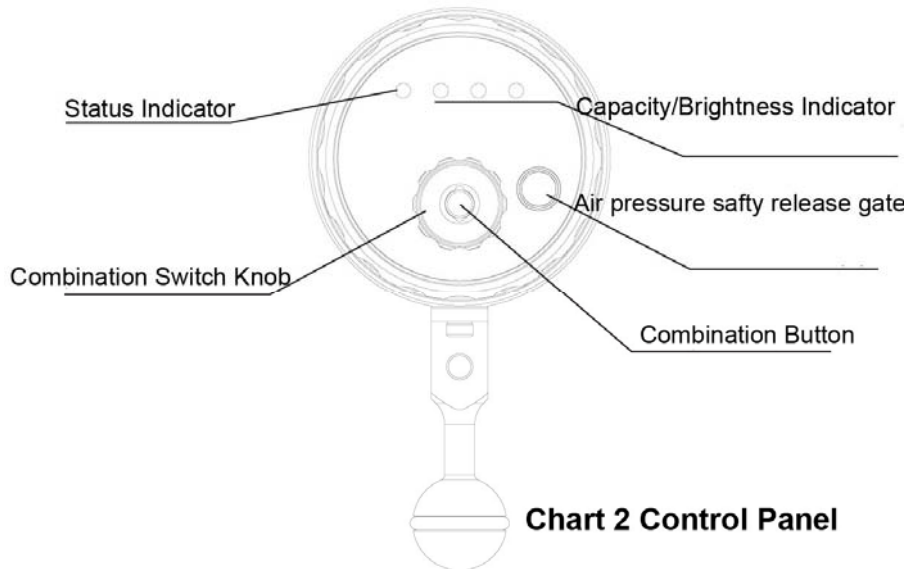

Chart 2 Control Panel

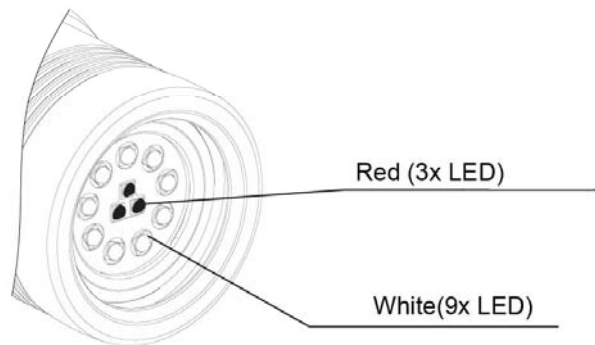

Chart 3 Instruction for light head

1.2 Specification

Brightness	White: 5000Lumen; Red: 150Lumen
Light Beam	White: 120degrees;Red:130degrees
Battery	11.1V/5200mAh Sanyo battery core lithium battery
Burn time	White Led around1 hour up, Red LED 10 hours up

Depth Rating	100m/330ft
LED spec	White: CREE XM-L T6*9PCS, Color temperature: 5700K~6500K
	Red: CREE XP-E R2*3PCS (Red, 620nm)
LED Life	Over 50000 hours
Materials	Aircraft degree aluminium+Hard anodized
Surface treatment	Hard anodized
Size	75.5(D)*141(L)mm
Weight	561g(under water, battery included) 1190g(on land, battery)
Function	White light step-less adjustment, white / red status indicator, Brightness level indicator, Battery status indicator, Low battery warning, Low battery protection, Temperature protection.
Special function	Air pressure safety release gate, Both sides of the battery are the same (no electrode design)

1.3 Package



① Video Light



② Lithium-ion Battery Pack

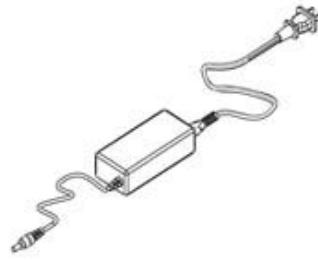

③ Charger



④ O Ring 2pcs



⑤ Silicone Grease

Chart 4 Package Included

II . Operation

2.1 Assembly For Battery

2.1.1 Anticlockwise unscrew the rear cap of the video light.

2.1.2 Insert Lithium-ion battery pack into the light, both sides of the battery are the same (no electrode design).

2.1.3 Clockwise turn the rear cap back to the light.

★ Notice: The rear must be turned back to the right place to avoid leaking.

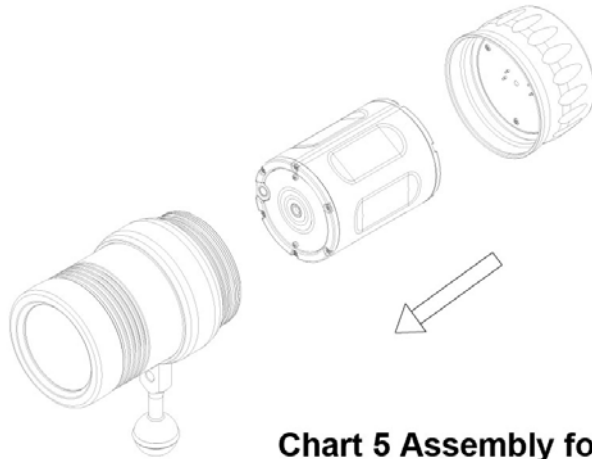

Chart 5 Assembly for battery

2.2 Turn On / Off Video Light

2.2.1 Turn on: Press combine button, the light will be turned on (Full 100% white is the default).

2.2.2 Turn off: Under any turn on mode, press the combine button for 3 seconds up, the light will be turned off.

2.2.3 Mode switching: Under the white mode and red mode, with a short press on the combine button (3 seconds down), and it will be switched to another mode by turns.

2.3 Fine Adjustment For Brightness Gear

Any brightness under white mode, switch the combine button anticlockwise, the brightness will be lighter. Otherwise, switch the combine button clockwise, the brightness will be darker.

2.4 Status Indicator



2.4.1 White Mode: The color of indicator is green.

2.4.2 Red Mode: The color of indicator is red.

2.5 Capacity Indicate

Capacity Status	Indicator
>75%	green
50%-75%	yellow
20%-50%	red
<20%	flicking red

2.6 Brightness indicate

Brightness Indicate			
71%-100%	on	on	on
31%-70%	on	on	off
10%-30%	on	off	off

2.7 Charger Usage

2.7.1 When Lithium-ion battery pack need to be charged, please insert the DC plug into the interface of the charger kit as following,

2.7.2 Then insert the AC plug into the power socket.

2.7.3 The indicator will turn green once the charge is completing.

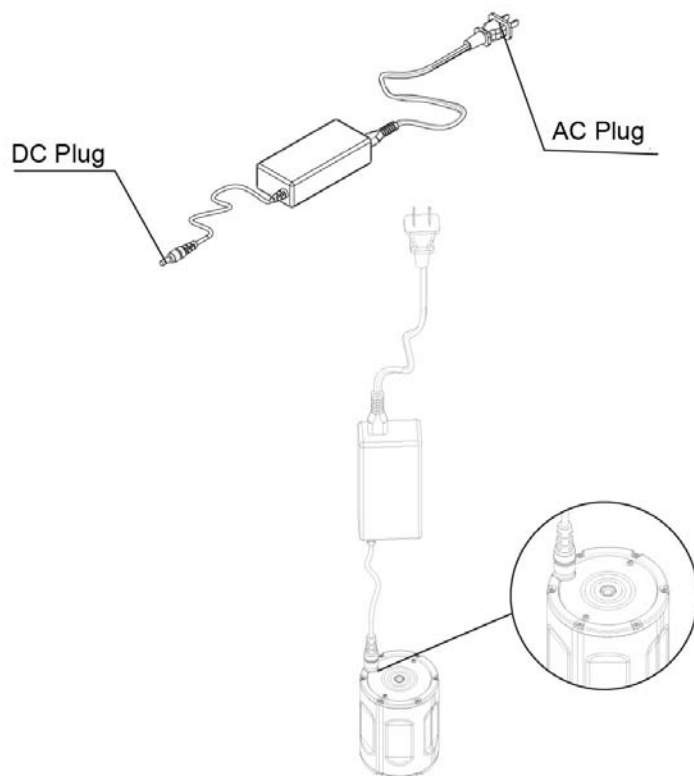

Chart 6 Battery Charge Instruction

2.8 Temperature Protection

If temperature reaches the setting value when you use the video light on land, program will decrease the brightness to 20% automatically. And will recover to its initial protected brightness automatically as soon as the temperature has been decreased.

2.9 Low Capacity Protection

When the light with a low capacity, the brightness will decrease to 20%, and the red indicator is flicking, then the light will be turned off automatically ten minutes later.

2.10 Silicone Grease Usage.

If it is very hard to switch the rear cap, or the O-ring inside the rear cap is dried-up after a long time use, please daub appropriate silicone grease.

2.11 O ring Replacement

When you find the o-ring inside the rear cap of the video light is broken or in bad- shaped, please remove the defective one, then replace a new one. Please daub appropriate silicone grease before replacing, any sharp tool is not allowed to avoid damaging O ring.

2.12 Precautions

- Any other battery is not allowed.
- Screw the rear cap when you diving.
- Against above operation requirement is not allowed.
- Long time no use, please remove the battery.